

PHILIPS

SpeechMike



SpeechMike Ambient (PSM5000)

User manual

Table of Contents

1. Important	3
Safety instructions	3
Cleaning and disinfection	3
Disposal of your old product	3
About this user manual	3
2. Your SpeechMike	5
Product highlights	5
What's in the box	6
Overview	7
Overview of the wireless adapter	7
Overview of the docking station	8
3. Get started	9
Charging the battery	9
Learn about the battery status	9
Turn the device on and off	10
Pairing	10
Learn about wireless technology	11
Idle mode	12
Locate your SpeechMike Ambient	12
Resetting the wireless connection	12
4. Use your SpeechMike Ambient	14
Utilization options	14
Create a recording	15
Customize the SpeechMike Ambient	15
Using the optimal audio mode	17
Upgrading the firmware	18
Supported shortcuts	19
5. Button modes	20
Switch between button modes	20
Event mode	21
Keyboard mode	22
Browser mode	23
Windows speech recognition mode	24
Dragon for Mac mode	25
Dragon for Windows mode	26
6. Troubleshooting	27
LED colors and meanings	28
Display icons and meanings	28
7. Technical data	29
SpeechMike Ambient	29
Wireless adapter	29
Docking station	29
System requirements	29
Charger information	29
8. Certifications	30
Europe	30
USA	30
Canada Statement	31
Protect Your Hearing: Follow These Safety Guidelines	31
Battery information	32
Open source software	32

1. Important

Do not make any adjustments and modifications that are not described in this manual. Follow all safety instructions to ensure proper operation of the device. The manufacturer assumes no liability for damages resulting from non-compliance with the safety instructions.

Safety instructions

- Protect the device from rain and liquids to prevent damage to the device or a short circuit.
- Do not expose the device to excessive heat caused by placing it on a heating device or in direct sunlight.
- Protect the cables from damage by being trapped, particularly at the plugs and where cables exit the housing.
- Do not perform any maintenance operations that are not described in this user manual. Do not disassemble the device into its component parts to carry out repairs. The device may only be repaired in authorized service centers.
- All wireless devices may be susceptible to interference, which could affect performance.
- Back up your data and recordings. The manufacturer's warranty does not cover loss of data resulting from user actions.
- Wearing the SpeechMike Ambient is not recommended if you have a pacemaker, due to possible interference.

Cleaning and disinfection

- Before cleaning, disconnect all cables from the device.
- To clean the device, use a soft dry cloth.
- To disinfect the device, use products for disinfection of surfaces in clinical areas and patient care equipment, such as surface disinfectant wipes.
- Do not use harsh chemicals or strong detergents.
- Avoid getting moisture in openings.
- Do not rub or strike the surface with anything hard or sharp as this may scratch or damage the surface permanently.

Disposal of your old product

Europe



A crossed-out wheeled bin symbol attached to a product indicates that the product is covered by the European Directive 2011/65/EU. Please get informed about the local separate collection system for electrical and electronic products. Please act according to your local rules and don't dispose of your old products with your normal household waste. Correct disposal of your old product helps to prevent potential negative consequences for the environment and human health.

United States

Rechargeable Li-ion battery:

- Your product is designed and manufactured with high quality materials and components, which can be recycled and reused. For recycling information, please contact your local waste management facilities or visit www.recycle.philips.com.
- This appliance contains a rechargeable lithium-ion battery which must be disposed of properly.
- Contact your local town or city officials for battery disposal information. You can also call 1-800-822-8837 or visit www.call2recycle.org for battery drop-off locations.
- For assistance, visit our website www.philips.com/support or call 1-800-243-3050 toll free.

Canada

Rechargeable Li-ion battery:

- Your product is designed and manufactured with high quality materials and components, which can be recycled and reused. For recycling information, please contact your local waste management facilities or visit www.recycle.philips.com.
- This appliance contains a rechargeable lithium-ion battery which must be disposed of properly.
- Contact your local town or city officials for battery disposal information. You can also call 888-224-9764 or visit www.call2recycle.ca for battery drop-off locations.
- For assistance, visit our website www.philips.com/support or call 1-800-243-7884 toll free.

About this user manual

Find a quick overview of your device on the next pages. For detailed description, see the following chapters of this user manual. Read the instructions carefully.

Symbols used



TIP

This symbol identifies information that helps you to use your device more efficiently and simply.



NOTE

This symbol indicates notices which you should observe when handling or operating the device.

**CAUTION**

This symbol warns of damage to the device and possible data loss. Damage can be caused by improper handling.

2. Your SpeechMike

We are delighted that you have chosen a Philips device. Visit our website for comprehensive support, such as user manuals, software downloads, warranty information and more: www.philips.com/dictation.

Product highlights

- Wireless recording and playback
- Long-lasting battery
- Superior recording quality
- Ergonomic design

What's in the box

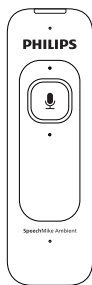

SpeechMike Ambient

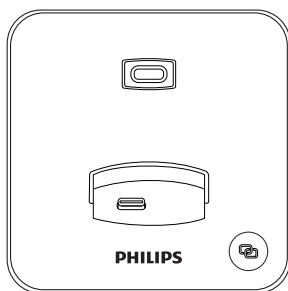

Docking station

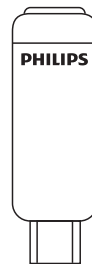

Wireless adapter

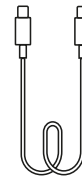

USB cable



Mounting clip

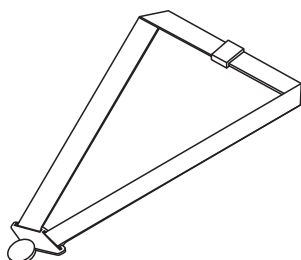

Neck strap

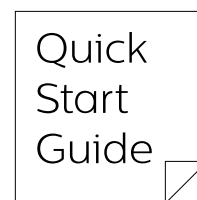

Quick start guide

Overview

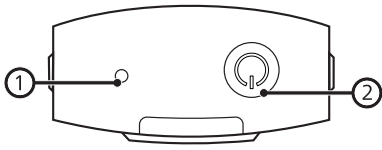

1. Connection LED
2. Power button

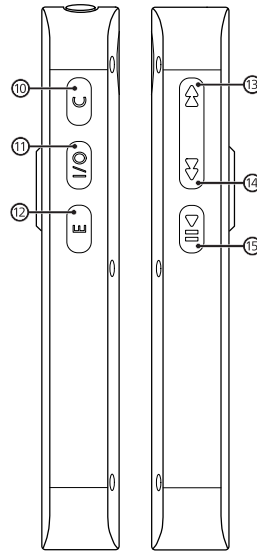

10. Command button
11. Insert/overwrite button
12. End-of-letter/priority button
13. Fast forward button
14. Rewind button
15. Play/pause button

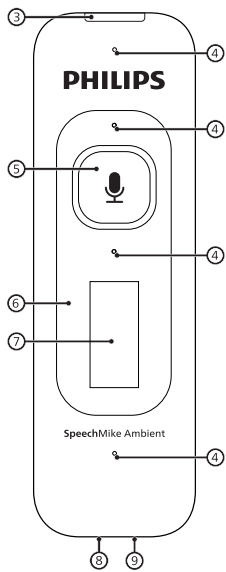

3. Record/Status LED
4. Microphone array
5. Record button
6. Speaker
7. Display
8. USB Type-C port
9. Headphones jack

Overview of the wireless adapter

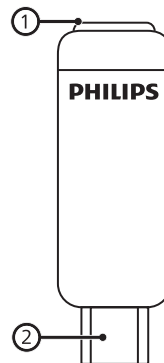

1. Connection LED
2. USB Type-C connector

Overview of the docking station

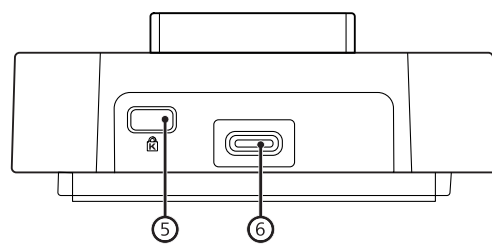
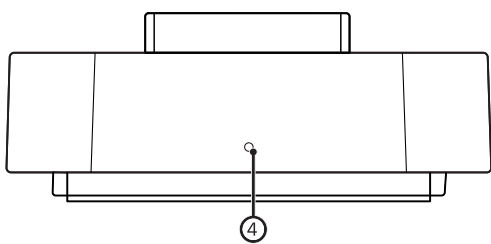
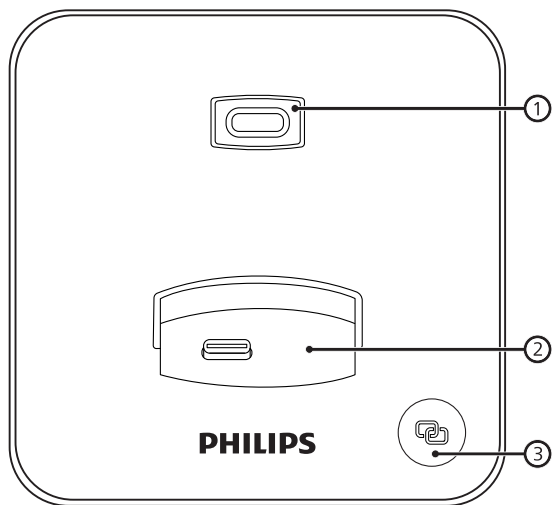

1. Wireless adapter connector
2. SpeechMike Ambient connector
3. Link button
4. Status LED
5. Kensington Security Slot
6. USB Type-C port

3. Get started



CAUTION

Before you connect the device, first read the [Safety instructions \[3\]](#).

Charging the battery

- Charge the built-in battery before you use the device for the first time or if you haven't used it for an extended time period.
- If the battery is completely discharged and your device turns off, allow the battery to charge for a while before you turn on the device.
- The device should be charged every 6 months even when not used, to prevent the battery from completely draining (deep discharge).
- The SpeechMike Ambient is charged by plugging it into a computer. However, if you turn off the computer, it may no longer charge. Some computers offer USB ports that still provide power when turned off; these are marked with a lightning bolt or a small tick. We recommend to use these when plugging in the SpeechMike Ambient or docking station. If this is unavailable, you can use a powered USB hub instead.

Charge via docking station

1. Connect the docking station to a computer.

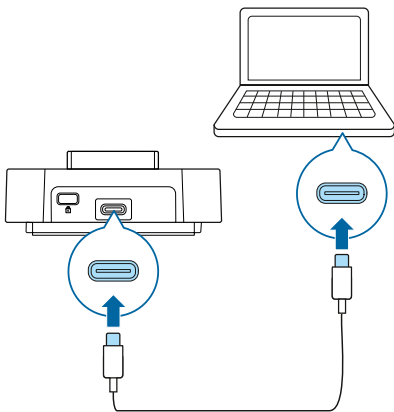



2. Insert the SpeechMike Ambient and the wireless adapter into the docking station.

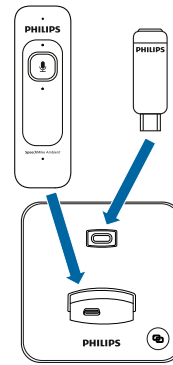

NOTE

Make sure that you insert the SpeechMike Ambient all the way to ensure its properly locked in place.



↳ The charging icon  is displayed on the SpeechMike Ambient display.

Charge via computer

- Connect the SpeechMike Ambient to a computer.

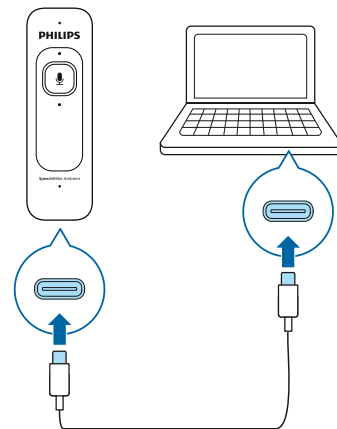





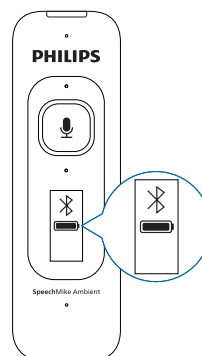

↳ The charging icon  is displayed on the SpeechMike Ambient display.

Learn about the battery status

Immediately after turning the SpeechMike Ambient on, the display indicates the battery status.



Battery	Battery status
 100%	more than 10 hours recording time left
 75%	7,5 hours or less recording time left
 50%	5 hours or less recording time left
 25%	2,5 hours or less recording time left
 Battery low	Please charge your SpeechMike Ambient to avoid any interruption to your work.
	Battery charging



TIP

You can always check the battery status of your SpeechMike Ambient by shortly pressing the Power button.

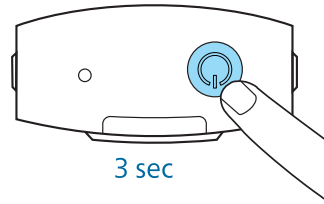

- Press and hold the Power button for about 3 seconds.
↳ The SpeechMike Ambient display turns itself off.

Pairing

Once you have connected your SpeechMike Ambient to a wireless adapter, you can dictate wirelessly and use the dictation microphone on different workstations without any further pairing effort.

Pair the SpeechMike Ambient and the wireless adapter in the docking station

1. Connect the docking station to your computer.
2. Insert the SpeechMike Ambient and the wireless adapter into the docking station.

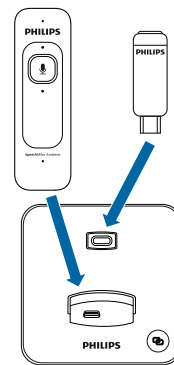

3. Press the link button on the docking station.

Turn the device on and off

To turn the device on:

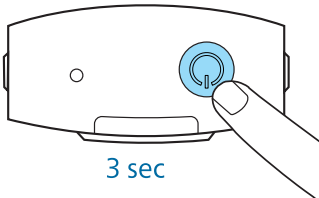

- Shortly place the device into the docking station or press and hold the Power button for about 3 seconds.
↳ The SpeechMike Ambient display turns itself on.

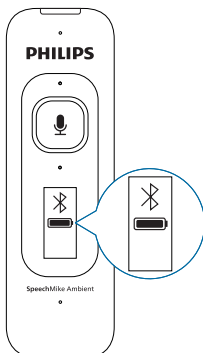

To turn the device off:

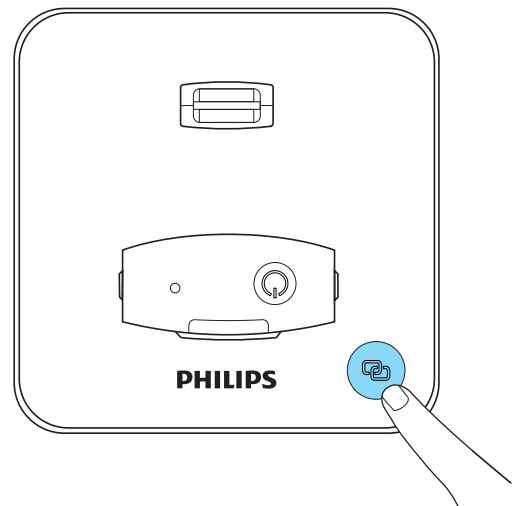

4. The pairing process starts.

↳ When pairing is finished, the connection LED on the SpeechMike Ambient and on the wireless adapter glow blue.

Pair the SpeechMike Ambient and the wireless adapter

You can also pair the SpeechMike Ambient and the wireless adapter directly without the docking station:

1. Insert the wireless adapter into the USB-C port of the SpeechMike Ambient.

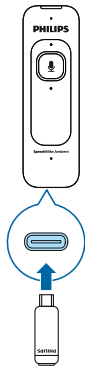

2. Hold the Command and the End-of-letter/priority button for 3 seconds.

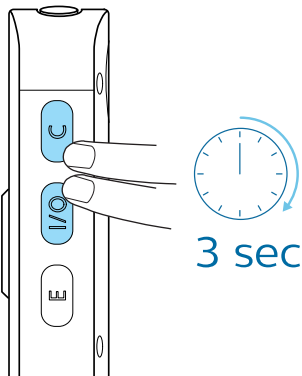

3.

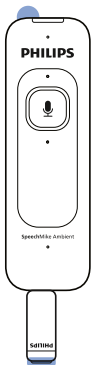

↳ When pairing is finished, the connection LED on the SpeechMike Ambient and on the wireless adapter glow blue.

4. Remove the wireless adapter from the SpeechMike Ambient.

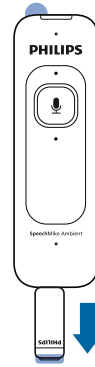

5. Connect the wireless adapter to your computer.

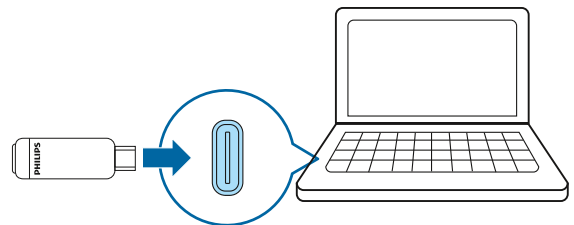

6.

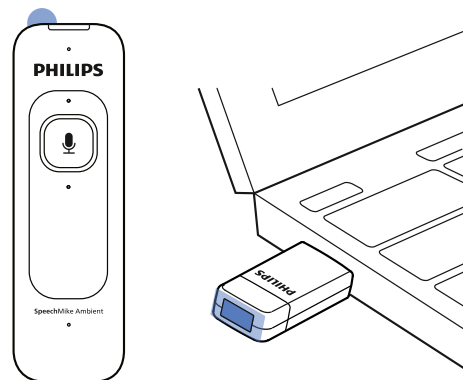

↳ Once reconnected, the connection LED on the SpeechMike Ambient and on the wireless adapter glow blue.

Learn about wireless technology

The SpeechMike Ambient uses Bluetooth wireless technology to establish a connection between the dictation microphone and the wireless adapter / docking station.

The Bluetooth connection doesn't require that the SpeechMike Ambient and the wireless adapter / docking station be in line of sight. However, the maximum distance between the SpeechMike Ambient and the wireless adapter should not be more than 25 meters (82 feet). The closer the devices are to each other, the better is the performance. The connection is subject to interference from distance and obstructions or other electronic devices.

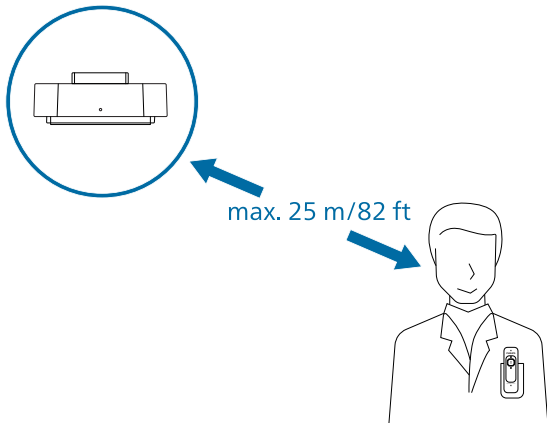

NOTE

If you encounter connection interferences, make sure to keep a minimum distance of 50 cm (18 inches) between the docking station and other wireless devices, such as smartphones or laptops. If the distance is less than 50 cm (18 inches), there might be interferences between the docking station and other wireless devices.

Going out of range

When the wireless connection is lost, the SpeechMike Ambient says **No connection**, the connection LED glows red and on the display the Bluetooth symbol is crossed out.

In this case, move closer to the docking station to reenter the reception area.

In this case, move closer to the wireless adapter / docking station to reenter the reception area.

↳ The connection is reestablished.

↳ The SpeechMike Ambient says **Connection established**, the connection LED glows blue and on the display the Bluetooth symbol is no longer crossed out.

Idle mode

After 4 minutes of inactivity, the SpeechMike Ambient automatically enters idle mode and the connection LED flashes blue. To reactivate the device, simply lift it up or press any button.

If the SpeechMike Ambient is not used for more than 10 hours, it automatically turns off to save battery life. To turn

the device on again, shortly place it into the docking station or press the Power button until the display turns on.



NOTE

In idle mode, the connection between the SpeechMike Ambient and the docking station is temporarily interrupted. When you reactivate the SpeechMike Ambient by lifting it up, the connection is immediately reestablished.



TIP

You can change and customize these default settings with Philips SpeechControl driver and configuration software. Download the software at www.dictation.philips.com/speechcontrol. For more information, see [Customize the SpeechMike Ambient \[15\]](#).

Locate your SpeechMike Ambient

If there are several SpeechMike Ambient in the room and you don't know which SpeechMike Ambient is connected to your computer, or you want to locate your SpeechMike Ambient quickly you can use SpeechControl:

1. Download and install the latest version of SpeechControl (Philips Device Control Center) from <https://www.dictation.philips.com/speechcontrol>.
2. Start Philips Device Control Center:
 - If the option to start the Philips Device Control Center automatically was selected during installation, open the program by clicking the  icon in the notification area of the Windows task bar.
3. On the **Troubleshooter** tab, click on the **Identify device** button on the right side.
 - ↳ The currently connected SpeechMike Ambient will beep shortly.

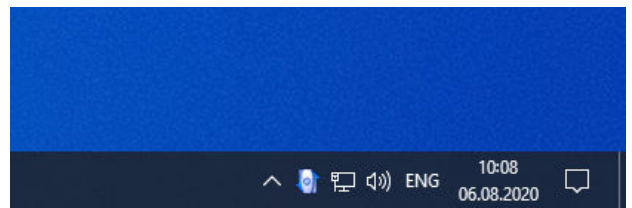

Resetting the wireless connection

If you should encounter problems with your device, for example, the SpeechMike Ambient doesn't respond or doesn't connect to the wireless adapter in the docking station, you can reset the wireless connection.

1. Disconnect the docking station from your computer.
 - ↳ All LEDs on the docking station are off now.
2. Press the Power button on the SpeechMike Ambient for about 5 seconds.

3. Connect the docking station to your computer.
4. Insert the SpeechMike Ambient and the wireless adapter into the docking station.

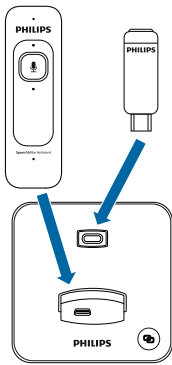

5. Press the link button on the docking station.

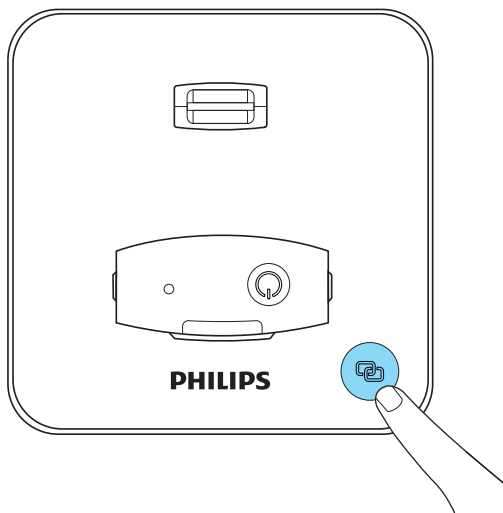

6. The pairing process starts.

↳ When pairing is finished, the connection LED on the SpeechMike Ambient and on the wireless adapter glow blue.



NOTE

If you experience connection problems, see [LED colors and meanings \[28\]](#).

4. Use your SpeechMike Ambient

Utilization options

You have different options to use your SpeechMike Ambient, depending on your work environment and personal preferences.

Use the mounting clip

1. Attach the mounting clip to the upper backside of your SpeechMike Ambient.

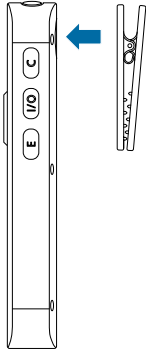

2. Use the clip to attach the SpeechMike Ambient to your clothing, for example in a breast pocket or directly on your shirt by pinching it directly to the fabric.

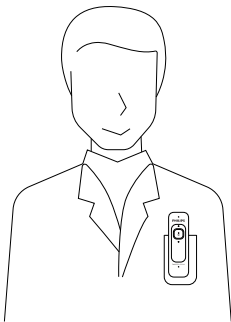

NOTE

Use the mounting clip to attach the SpeechMike Ambient to your clothes, as you would with a clothes peg. Do not attach the mounting clip behind the fabric of your shirt to hold it in place just with the magnet.

3. Ensure that the microphone array of your SpeechMike Ambient is aligned vertically.

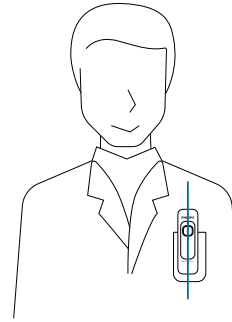

Use the neck strap

1. Attach the neck strap to the upper backside of your SpeechMike Ambient.

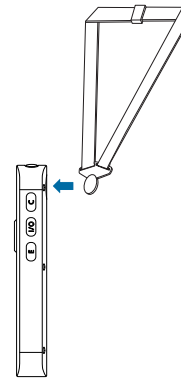

2. Hang the SpeechMike Ambient around your neck using the neck strap.

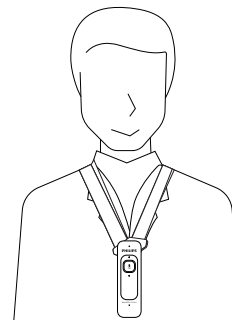

NOTE

Ensure that the microphones of your SpeechMike Ambient are not covered (e.g. when you cross your arms in front of it) and that the SpeechMike Ambient is positioned freely and vertically to enable the best sound quality.

Use in the docking station

1. Insert your SpeechMike Ambient into the docking station.

- When recording, ensure that you are not too far away from the SpeechMike Ambient in the docking station. The optimal distance is 40-50 cm or 15-20 inch.

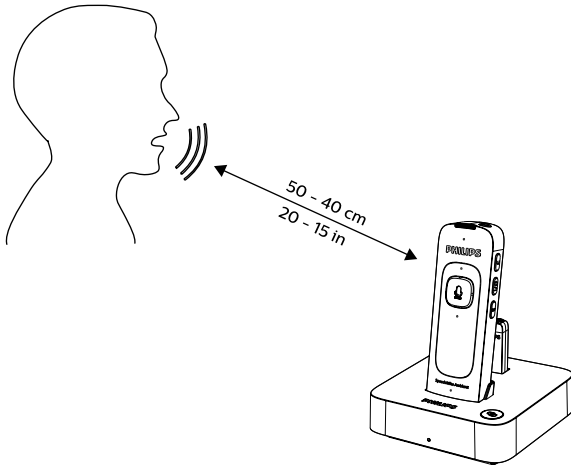

Use on a desk

- Place your SpeechMike Ambient lengthwise on a desk between both speakers.
- When recording, ensure that you are not too far away from the SpeechMike Ambient. The optimal distance is 40-50 cm or 15-20 inch.

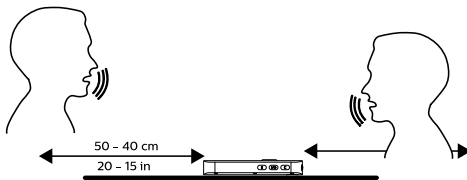

NOTE

We recommend to use the **Ambient mode** when using the SpeechMike Ambient on a desk. See [Using the optimal audio mode \[17\]](#) for more information.

Create a recording

Recording and playback of dictations with the SpeechMike Ambient requires dictation software such as Philips SpeechLive or the SpeechLive Mobile App.

For more information on how to use SpeechLive or the SpeechLive Mobile App visit www.speechlive.com/help.



NOTE

- Make sure that the distance between the SpeechMike Ambient and the wireless adapter / docking station is not more than 25 meters (82 feet). For more information, see [Learn about wireless technology \[11\]](#).
- If there are any objects between the SpeechMike Ambient and the wireless adapter, reduce the transmission distance if possible.
- When recording, try to position yourself in line with the wireless adapter and ensure that your body is not obstructing the signal.

Customize the SpeechMike Ambient

Use the Device Control Center software to customize the SpeechMike Ambient to suit individual user needs.

The software allows to assign different functions to each key, enable or disable certain features and also to start and control applications with the SpeechMike Ambient.

Customize SpeechMike Ambient keys and settings

- Connect the SpeechMike Ambient to your computer via the docking station. Alternatively, you can connect the SpeechMike Ambient to your computer via a USB-C cable, as long as the wireless adapter and the SpeechMike Ambient are both paired to the same computer.
- Download and install the latest version of SpeechControl (Philips Device Control Center) from <https://www.dictation.philips.com/speechcontrol>.
- Start Philips Device Control Center:
 - If the option to start the Philips Device Control Center automatically was selected during installation, open the program by clicking the  icon in the notification area of the Windows task bar.

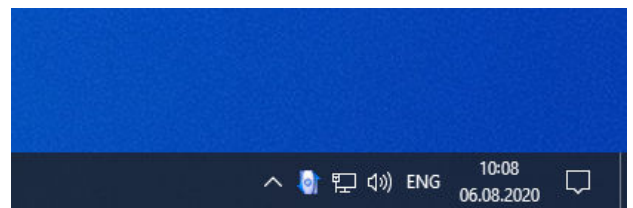

- To manually start the program, open the Windows start menu in Windows and select Philips Speech Control > Philips Device Control Center.

The current settings are automatically downloaded from the connected SpeechMike Ambient.

- On the **Device** tab, configure device settings and select the function to be assigned to each key.
- Click the **Upload** button to save the new settings.



NOTE

The SpeechMike Ambient can be reset to its factory default configuration by clicking the **Defaults** button. Click the **Upload** button to save the default settings.



TIP

To test settings and key functions, use the **Device test** section on the **Device** tab.

Use application shortcuts

The Device Control Center software allows to start and control other applications with the keys on the SpeechMike Ambient.

The Device Control Center software includes pre-installed profiles that make the SpeechMike Ambient ready for immediate operation with Dragon NaturallySpeaking speech recognition software and Microsoft Powerpoint. Additional profiles for other applications can be programmed.

1. Download and install the latest version of Speech-Control (Philips Device Control Center) from <https://www.dictation.philips.com/speechcontrol>.
2. If the option to start the Device Control Center automatically was selected during installation, the application icon appears in the notification area of the Windows task bar.
To manually start the program, open the Windows start menu in Windows and select Philips Speech Control > Philips Device Control Center.
3. Right-click on the application icon in the notification area of the Windows task bar and verify that **Activate application control** is enabled. If the option is disabled, the configured settings and buttons will not function for any of the target applications.

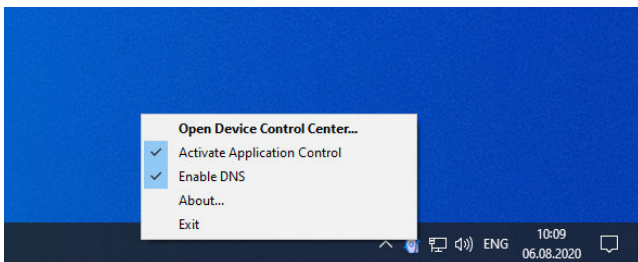

Default profile

The default profile is applied automatically when there is no profile assigned to an application in focus. This profile is set up to control Dragon NaturallySpeaking with your SpeechMike Ambient. The following settings are defined:

SpeechMike Ambient key	Assigned shortcut
● Record	Record (push to dictate)
▶ Play/Stop	Play from cursor position
◀◀ Rewind	Move cursor backwards
▶▶ Fast forward	Move cursor forwards

SpeechMike Ambient key	Assigned shortcut
• EOL/•• PRIO	Mark backwards
INS/OVR	Open correction window

Powerpoint profile

Use this profile to control Powerpoint presentations with the SpeechMike Ambient. The following settings are defined:

SpeechMike Ambient key	Assigned shortcut
● Record	Black screen
▶ Play/Stop	White Screen
◀◀ Rewind	Go to previous slide
▶▶ Fast forward	Go to next slide
• EOL/•• PRIO	End slide show
INS/OVR	Show/hide cursor



NOTE

Philips cannot guarantee the proper function of all assigned shortcuts, since shortcuts can differ among versions and languages.

Program a custom profile

It is possible to program shortcuts for other applications to control application functions with the keys of the SpeechMike Ambient.

1. Connect the SpeechMike Ambient to your computer via the docking station. Alternatively, you can connect the SpeechMike Ambient to your computer via a USB-C cable, as long as the wireless adapter and the SpeechMike Ambient are both paired to the same computer.
2. Download and install the latest version of Speech-Control (Philips Device Control Center) from <https://www.dictation.philips.com/speechcontrol>.
3. Start Philips Device Control Center:
 - If the option to start the Philips Device Control Center automatically was selected during installation, open the program by clicking the icon in the notification area of the Windows task bar.

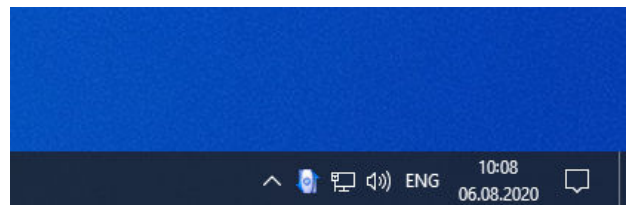

- To manually start the program, open the Windows start menu in Windows and select Philips Speech Control > Philips Device Control Center.
4. On the tab **Application control**, click the **Add** button to create a new profile.
 5. Browse and select the application executable and click on **Open**. A profile for the selected application will be added to the list of profiles.



NOTE

Exit the target application during configuration. Open the application when the device configuration settings are saved.



TIP

Application control configuration settings can be saved into files and imported later to apply the same configuration settings to several devices.

- Select a button from the button column and click the  icon to assign a shortcut. You can assign different shortcuts for pressing and releasing a key. The shortcut editor window is displayed.

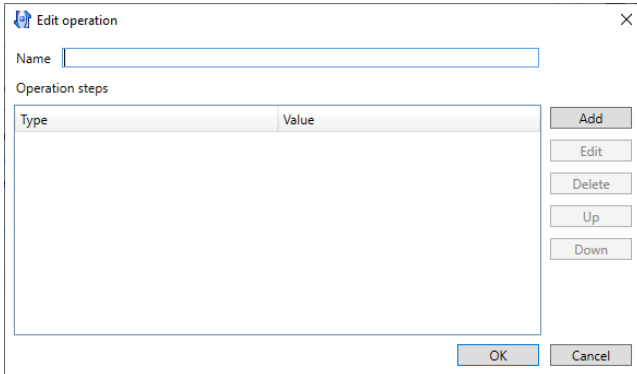

- Enter name for the shortcut and click the **Add** button to add an operation for the shortcut. The following options are available:

- **Hotkey:** Assign a keyboard shortcut
- **Text:** Enter the text to be inserted when a key on the SpeechMike Ambient is pressed
- **Start application:** Start an application by pressing a key on the SpeechMike Ambient
- **Mouse button**
- **Dragon NaturallySpeaking command**
- **Delay**

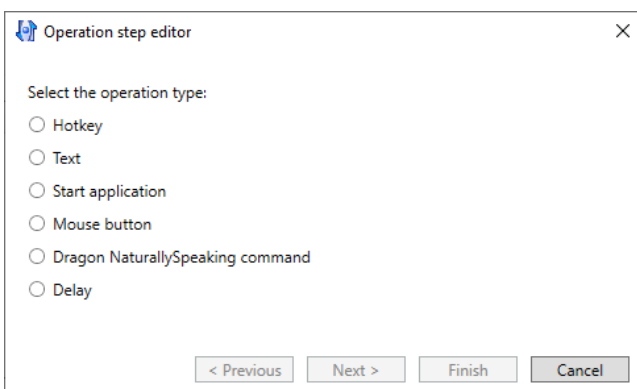

- You can add one operation or a sequence of operations for every shortcut.
- Click the **Finish** button to save the new settings.



NOTE

The Device Control Center cannot be used to program application shortcuts for Philips SpeechExec software. Shortcuts for Philips SpeechExec can be configured in the General settings menu of SpeechExec. See the SpeechExec application help for more information.

Use the motion sensor

The SpeechMike Ambient features an integrated motion sensor that detects when the device is put on the table and is being picked up again. The motion sensor can mute and unmute the microphone automatically or custom functions can be programmed, e.g., to pause and to continue recording. Use the Device Control Center software to enable automatic muting of the microphone (**Device > Advanced settings > Microphone motion control**) or to program custom functions (**Application control** tab).

Using the optimal audio mode

You can change the audio mode of your SpeechMike Ambient with SpeechControl (Philips Device Control Center).

- Connect the SpeechMike Ambient to your computer via the docking station. Alternatively, you can connect the SpeechMike Ambient to your computer via a USB-C cable, as long as the wireless adapter and the SpeechMike Ambient are both paired to the same computer.
- Download and install the latest version of SpeechControl (Philips Device Control Center) from <https://www.dictation.philips.com/speechcontrol>.
- Start Philips Device Control Center:
 - If the option to start the Philips Device Control Center automatically was selected during installation, open the program by clicking the  icon in the notification area of the Windows task bar.

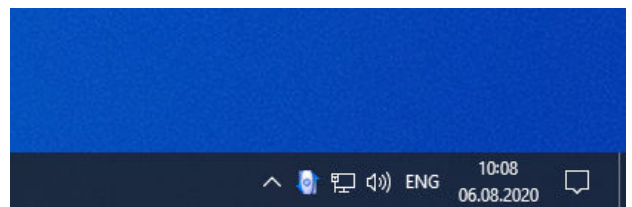

- To manually start the program, open the Windows start menu in Windows and select Philips Speech Control > Philips Device Control Center.

The current settings are automatically downloaded from the connected SpeechMike Ambient.

- On the **Device** tab, under **Advanced settings** scroll down to the **Audio mode** section, here you can switch between different audio modes:

Ambient mode

This mode is used for the following use cases:

- Single user applications where there is no disturbing noise in the room
- Conversation recordings that do the speaker separation within the software (e.g. Microsoft Dragon Copilot)

Dictation mode (single speaker)

This mode is used for single-user dictation applications like DMO, SpeechExec, SpeechLive.

When the SpeechMike Ambient is worn it separates the user from other disturbing voices in the room and sends a mono audio signal to the computer.

In any other position (in the docking station or when lying on the desk) the SpeechMike Ambient switches to Ambient mode.

Integrator mode 1





This mode is used for conversation recordings where the backend software does not have speaker separation built in. The SpeechMike Ambient separates the user from other voices in the room and sends a stereo audio signal to the computer. This mode is only available via the SDK or the SpeechControl software.

Integrator mode 2

This mode is used for conversation recordings where the backend software does not have speaker separation built in. The SpeechMike Ambient separates the user from other voices in the room and sends a stereo audio signal to the computer. This mode is only available via the SDK or the SpeechControl software.

Change the audio mode via buttons

You can also change the audio mode directly on your SpeechMike Ambient:

1. Hold the Command button, then press Record to switch between the different audio modes
2. When switching between the audio modes, the display will show an icon of the currently selected audio mode:
 -  Ambient mode
 -  Dictation mode
 -  Integrator mode 1*
 -  Integrator mode 2*

*only visible if the Integration mode was enabled via the SDK or SpeechControl software

Upgrading the firmware

Your device is controlled by an internal program called firmware. As a part of ongoing product maintenance, the firmware is upgraded and errors are corrected.

It is possible that a newer version (an 'update') of the firmware has been released since you purchased the device. In this case, you can easily update your device to the latest version.

Use SpeechControl (Philips Device Control Center) to upgrade the firmware of your device. You can download the latest version of the application here: <https://www.dictation.philips.com/speechcontrol>. Please follow the steps outlined below to upgrade your device.

To upgrade your device:

1. Connect the SpeechMike Ambient to your computer via the docking station. Alternatively, you can connect the SpeechMike Ambient to your computer via a USB-C cable, as long as the wireless adapter and the SpeechMike Ambient are both paired to the same computer.
2. Start Philips Device Control Center:
 - If the option to start the Philips Device Control Center automatically was selected during installation, open

the program by clicking the  icon in the notification area of the Windows task bar.

- To manually start the program, open the Windows start menu in Windows and select Philips Speech Control > Philips Device Control Center.



NOTE

Make sure that you're using the [latest version of Philips Device Control Center](#).

3. On the **Device** tab, click on **Firmware upgrade**.
4. Click on the desired upgrade version from the **Available firmware versions** list.

If the **Available firmware versions** list is empty, you can also manually check our website for firmware upgrades. Download the firmware update for your SpeechMike model from www.philips.com/dictation. Click the **Import** button and select the folder with the firmware files to be imported.
5. Click the **Upgrade** button.
6. Choose **Yes, upgrade the device** to install the new firmware.
 - The firmware upgrade takes about 30 seconds.







CAUTION

Do not disconnect the dictation microphone from the computer during firmware upgrade. This might damage your product.

Supported shortcuts

You can activate/deactivate some functions of your SpeechMike Ambient by pressing certain key combinations:

Function	Shortcut	Hold buttons for:	Indication
Set pairing mode (see Pairing [10] for more details)	Command + Insert/overwrite/append	3 seconds	<ul style="list-style-type: none"> If the wireless adapter is connected to the SpeechMike Ambient, it will pair with it. If you're using the SpeechMike Ambient without the adapter, the 6-digit Bluetooth PIN is displayed.
Incognito mode on/off When you turn the incognito mode on/off, it overwrites all LED, display and sound settings:	End-of-letter/priority + Record	3 seconds	When active, the incognito icon is displayed on the screen.
Display the serial number and firmware version	Command + Play	3 seconds	The serial number and firmware version is displayed on the screen.
Change the audio mode	Hold the Command button, then press Record to switch between the different audio modes	-	<p>When switching between the audio modes, the display will show an icon of the currently selected audio mode:</p> <ul style="list-style-type: none">  Ambient mode  Dictation mode  Integrator mode 1*  Integrator mode 2* <p>*only visible if the Integration mode was enabled via the SDK or SpeechControl software</p> <p>See Using the optimal audio mode [17] for more information about the different audio modes.</p>

5. Button modes

With your SpeechMike Ambient, you can control various applications on your computer or in your browser. You have different button modes available for this purpose:

- [Event mode \[21\]](#)
- [Keyboard mode \[22\]](#)
- [Browser mode \[23\]](#)
- [Windows speech recognition mode \[24\]](#)
- [Dragon for Windows mode \[26\]](#)
- [Dragon for Windows mode \[26\]](#)

You can change the button assignment for each mode in SpeechControl software. Download the software for free at www.dictation.philips.com/speechcontrol.

Switch between button modes

1. Connect the SpeechMike Ambient to your computer via the docking station. Alternatively, you can connect the SpeechMike Ambient to your computer via a USB-C cable, as long as the wireless adapter and the SpeechMike Ambient are both paired to the same computer.
2. Download and install the latest version of SpeechControl (Philips Device Control Center) from <https://www.dictation.philips.com/speechcontrol>.
3. Start Philips Device Control Center:
 - If the option to start the Philips Device Control Center automatically was selected during installation, open the program by clicking the  icon in the notification area of the Windows task bar.

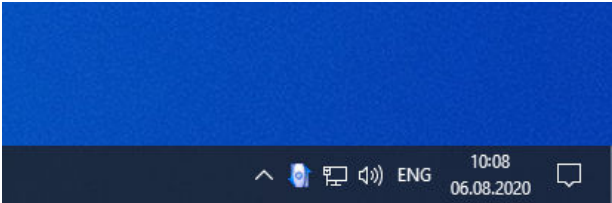

- To manually start the program, open the Windows start menu in Windows and select Philips Speech Control > Philips Device Control Center.

The current settings are automatically downloaded from the connected SpeechMike Ambient.

4. Open the **Device** tab and choose **Button configuration** on the left. Select the desired button mode from the drop down menu, then click on the **Upload**  button to upload the new settings to your SpeechMike Ambient.

Event mode

The Event mode is the default mode of your SpeechMike Ambient. In this mode, each button on your SpeechMike Ambient is assigned to a command. In SpeechControl software, you can define which commands should be executed by pressing or releasing a desired button on your SpeechMike Ambient in order to control various computer applications.

Command	
1	Record
2	Fast forward
3	Fast rewind
4	Play
5	Command
6	Insert/overwrite/append
7	End-of-letter/priority

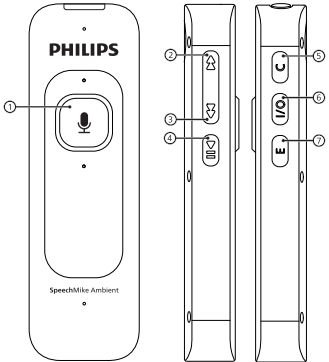

Keyboard mode

Assign a button on your SpeechMike Ambient to a shortcut you are using on your computer in order to control various computer applications. In SpeechControl software, you can define which commands should be executed by pressing a desired button on your SpeechMike Ambient.

In this mode, you can also operate Dragon NaturallySpeaking speech recognition software on a Windows computer by using the pre-configured Dragon shortcuts.

	Command	Shortcut in SpeechControl
1	SpeechMike microphone on/ off	Microphone ON/OFF
2	Next field (Dragon)	Ctrl+Shift+N
3	Mark previous word(s)	Ctrl+Shift+Left
4	Play	Return
5		
6	Tab forward	Tab
7	Tab backward	Shift+Tab

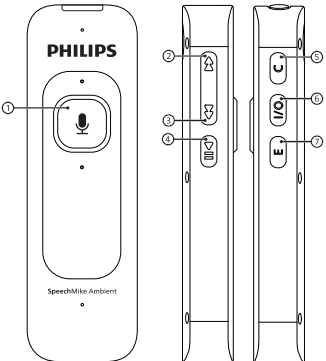

Browser mode

Assign a SpeechMike Ambient button to a shortcut or a command in your browser in order to control various browser based dictation applications. In SpeechControl software, you can define which commands should be executed by pressing a desired button on your SpeechMike Ambient.

Command	
1	Record
2	Fast forward
3	Fast rewind
4	Play
5	Command
6	Insert/overwrite/append
7	End-of-letter/priority

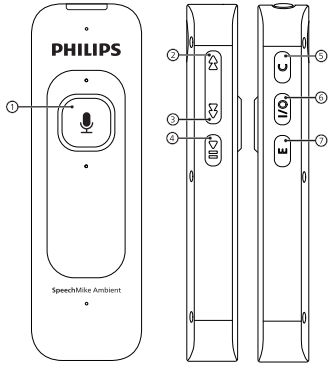

The diagram shows the Philips SpeechMike Ambient device from three perspectives. The front view shows a microphone and a small display area. The side views show the device's profile with various buttons and indicators. Numbered callouts 1 through 7 point to specific features: 1 points to the microphone, 2 points to the top button, 3 points to the second button, 4 points to the third button, 5 points to the fourth button, 6 points to the fifth button, and 7 points to the sixth button.

Windows speech recognition mode

In this mode, you can operate the pre-installed Windows speech recognition software on a Windows computer by using the pre-configured Windows shortcuts.

Command		Shortcut in Speech-Control
1	Windows microphone on/off	Ctrl+Win
2	Mark next word(s)	Ctrl+Shift+Right
3	Mark previous word(s)	Ctrl+Shift+Left
4		Return
5		
6	Next field (Dragon)	Tab
7	Tab backward	Shift+Tab

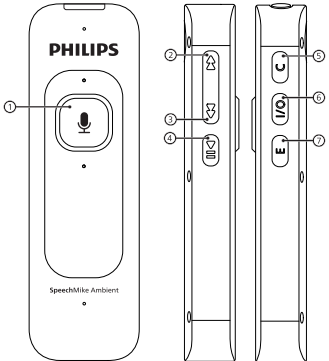

The diagram illustrates the Philips speech recognition device. On the left is a front view of the device, showing the microphone and the 'PHILIPS' logo. On the right are two side views of the device, showing the control buttons. The top button is labeled 'PHILIPS' and is used for turning the microphone on/off. The middle button is labeled 'M' and is used for marking the next word(s). The bottom button is labeled 'L' and is used for marking the previous word(s). The device also features a 'SpeechAlive Ambient' sensor at the bottom.

Dragon for Mac mode

In this mode, you can operate Dragon NaturallySpeaking speech recognition software on a Mac computer by using the pre-configured Dragon shortcuts.

	Command	Shortcut in Speech-Control
1	Dragon microphone on/off	⌘+F11
2	Mark next word(s)	Alt+Shift+Right
3	Mark previous word(s)	Alt+Shift+Left
4	Play	
5		
6	Tab forward	Tab
7	Tab backward	Shift+Tab

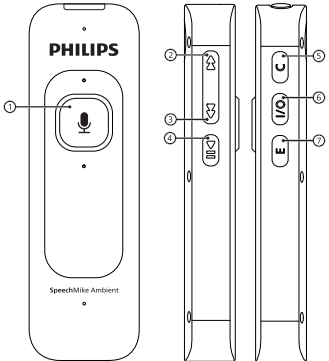

The diagram shows the Philips Dragon microphone and its side buttons. The front view shows the microphone grille and the 'PHILIPS' logo. The side view shows the microphone's profile with several buttons labeled with numbers 1 through 7. Button 1 is the microphone on/off button. Buttons 2 and 3 are the mark next/previous word buttons. Buttons 4 and 5 are the play/pause buttons. Buttons 6 and 7 are the tab forward/backward buttons.

Dragon for Windows mode

In this mode, you can operate Dragon NaturallySpeaking speech recognition software on a Windows computer by using the pre-configured Dragon shortcuts.

	Command	Shortcut in Speech-Control
1	Dragon microphone on/off	NumKey+
2	Next field (Dragon)	Ctrl+Shift+N
3	Tab backward	Ctrl+Shift+Left
4	Play	F7
5		
6	Tab forward	Tab
7	Mark previous word(s)	Shift+Tab

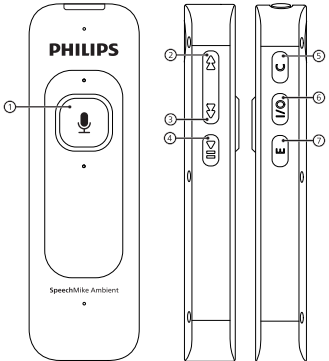

6. Troubleshooting







Find the most common problems you could encounter with the SpeechMike Ambient in the following table. If you are unable to solve the problem with the information below, contact the supporting Philips partner you purchased the device from.

Problem	Cause	Solution
The SpeechMike Ambient doesn't respond to input commands.	<ul style="list-style-type: none"> The wireless connection to the docking station may be interrupted. Your computer is in sleep mode. The battery is empty. 	<ul style="list-style-type: none"> Check the wireless connection. Move closer to the docking station. Start the pairing process as described in the chapter Pairing [10]. Wake your computer from sleep mode. Charge the SpeechMike Ambient. If none of the solutions provided above solves the problem, reset the wireless connection. For more information, see Resetting the wireless connection [12].
The SpeechMike Ambient doesn't switch on.	<ul style="list-style-type: none"> The battery is very low. 	<ul style="list-style-type: none"> Charge the SpeechMike Ambient.
The SpeechMike Ambient doesn't connect to the wireless adapter.	<ul style="list-style-type: none"> Pairings may have been reset or the SpeechMike Ambient has been previously paired with another docking station. 	<ul style="list-style-type: none"> Start the pairing process as described in the chapter Pairing [10]. If re-pairing doesn't solve the problem, reset the wireless connection. For more information, see Resetting the wireless connection [12].
The SpeechMike Ambient is connected to the computer but sound will play on the computer's speaker only	<ul style="list-style-type: none"> SpeechMike Ambient is not selected as the default playback device. 	<ul style="list-style-type: none"> In the Windows sound settings, select SpeechMike Ambient as the default playback device.
The SpeechMike Ambient doesn't record sound.	<ul style="list-style-type: none"> The input level is too low because of the wrong recording source. 	<ul style="list-style-type: none"> In the Windows sound settings, select SpeechMike Ambient as the default recording device.
The magnet clip doesn't hold the SpeechMike Ambient in place.	<ul style="list-style-type: none"> The mounting clip is used behind the fabric of your shirt. 	<ul style="list-style-type: none"> Use the mounting clip to attach the SpeechMike Ambient to your clothes, as you would with a clothes peg. Do not attach the mounting clip behind the fabric of your shirt to hold it in place just with the magnet. See Utilization options [14] for more information.
The recording quality is very low.	<ul style="list-style-type: none"> The microphones of your SpeechMike Ambient are covered. 	<ul style="list-style-type: none"> Ensure that the microphones of your SpeechMike Ambient are not covered (e.g. when you cross your arms in front of it) and that the SpeechMike Ambient is positioned freely and vertically to enable the best sound quality. See Utilization options [14] for more information.
The wireless connection is poor.		<ul style="list-style-type: none"> Make sure that the distance between the SpeechMike Ambient and the wireless adapter / docking station is not more than 25 meters (82 feet). For more information, see Learn about wireless technology [11]. If there are any objects between the SpeechMike Ambient and the wireless adapter, reduce the transmission distance if possible. When recording, try to position yourself in line with the wireless adapter and ensure that your body is not obstructing the signal.

LED colors and meanings

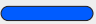



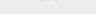
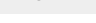



The LEDs on your SpeechMike Ambient and the docking station indicate the connection and battery status as well as problems that might occur when using your SpeechMike Ambient and the docking station. Use the following table to learn more about the connection status, battery status, and potential problems:

Connection LED

SpeechMike Ambient	Wireless adapter	Meaning
 blue	 blue	• connection OK
 red	 blue	• connection interrupted
 off	 red	• SpeechMike Ambient power off
 red	 off	• Wireless adapter not plugged in
 red	 red	• no pairing

Display icons and meanings

Depending on the active function, the SpeechMike Ambient displays different icons on its screen to indicate current status or usage.

Icon	Meaning
	A Bluetooth connection has been successfully established.
	Bluetooth connection not established.
	Bluetooth connection available but no data connection via USB.
	Battery charging
	Incognito mode (both LEDs and audible signals are switched off)
	Only audible signals are switched off
	Only LEDs are switched off
	External microphone connected
	External earphones connected

7. Technical data

SpeechMike Ambient

Wireless connectivity

Wireless technology	2.4 GHz Bluetooth Low Energy
Maximum Power	≤ 10mW
Maximum range	up to 25 m / 82 ft (in clear view)

Audio

Microphone type	MEMS 4-way microphone array
Characteristic	omni-directional and beam forming
Frequency response	200 – 8000 Hz

Sound

Speaker type	built-in rectangular, dynamic speaker
Acoustic frequency response	300 – 8000 Hz
Speaker output power	> 200 mW

Power

Battery type	Li-polymer
Rechargeable	via docking station or USB-C Power supply 5V 0.5A
Battery lifetime	up to 10 hours continuous talk time
Charging time	3h

Product dimensions

Product dimensions (W × D × H)	32 × 104 × 15 mm / 1.25 × 4.09 × 0.59 in
Weight	42 g / 1.48 oz.

Wireless adapter

Product dimensions (W × D × H)	14 × 7 × 42.5 mm / 0.55 × 0.27 × 1.67 in
Weight	4 g / 0.14 oz.

Docking station

Product dimensions (W × D × H)	85 × 85 × 32 mm / 3.35 × 3.35 × 1.26 in
Weight	140 g / 4.94 oz.
USB-C	for charging and Data connection

USB-C	for BLE Wireless Adapter
Kensington Lock	

System requirements

Processor	Intel dual core or equivalent AMD processor, 1 GHz or faster processor
RAM	2 GB (32 bit)/4 GB (64 bit)
Hard-disk space	30 MB for SpeechControl software, 4.5 GB for Microsoft .NET Framework
Operating system	Windows 11, Windows 10 (64 bit)
Graphics	DirectX-compliant graphics card with hardware acceleration recommended
Sound	Windows-compatible sound device
Free USB-C port	
Supported speech recognition software	Nuance Dragon Professional 12.5/13/14/15/16 Individual/Group, Nuance Dragon Legal 12.5/13/14/15/16, Dragon Medical Practice Edition 2/3, Dragon Medical One, Solventum Fluency Direct 8.0 and above, Fluency for Imaging 3 and above, Fusion Narrate powered by nVoq

Charger information

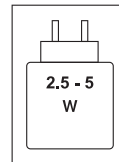

The power delivered by the charger must be between min 2.5 Watts required by the radio equipment, and max 5 Watts in order to achieve the maximum charging speed.

8. Certifications

Europe



CE declaration of conformity

Manufactured for:	Speech Processing Solutions GmbH, Gutheil-Schoder-Gasse 8–12, 1100 Wien, Österreich www.philips.com/dictation
Brand:	Philips
Product name:	Philips SpeechMike Ambient
Model:	PSM5000
Operating temperature:	5° – 45° C / 41° – 113° F

SpeechMike Ambient (PSM5000)

Hereby, Speech Processing Solutions GmbH declares that the radio equipment device is in compliance with Directive 2014/53/EU as well as UK Radio Equipment Regulations SI 2017 No.1206. The full text of the EU/UK declaration of conformity is available at the following internet address CE and for UK: <https://www.dictation.philips.com/en/philips-speech-mike-ambient-wearable-ki-assistent-psm5000-serie/>

Product name and model number: SpeechMike Ambient PSM5000

- 1) Operation Frequency : 2402 MHz ~ 2480 MHz
- 2) Modulation Type: GFSK
- 3) Maximum power value measured in actual operation: 9,27 mW eirp max
- 4) Tune up Range value: 10dBm +/- 2dBm

Wireless adapter (ACC5100)

Hereby, Speech Processing Solutions GmbH declares that the radio equipment device is in compliance with Directive 2014/53/EU as well as UK Radio Equipment Regulations SI 2017 No.1206. The full text of the EU/UK declaration of conformity is available at the following internet address CE and for UK: <https://www.dictation.philips.com/en/philips-speech-mike-ambient-wearable-ki-assistent-psm5000-serie/>

Product name and model number: Wireless Adapter ACC5100

- 1) Operation Frequency : 2402 MHz ~ 2480 MHz
- 2) Modulation Type: GFSK
- 3) Maximum power value measured in actual operation: 9,06 mW eirp max

- 4) Tune up Range value: 9.6 dBm +/- 2dBm

USA

SpeechMike Ambient (PSM5000)

FCC Statement

This equipment has been tested and found to comply with the limits for a Class B digital device, pursuant to Part 15 of the FCC Rules. These limits are designed to provide reasonable protection against harmful interference in a residential installation. This equipment generates uses and can radiate radio frequency energy and, if not installed and used in accordance with the instructions, may cause harmful interference to radio communications. However, there is no guarantee that interference will not occur in a particular installation.

If this equipment does cause harmful interference to radio or television reception, which can be determined by turning the equipment off and on, the user is encouraged to try to correct the interference by one or more of the following measures:

- Reorient or relocate the receiving antenna.
- Increase the separation between the equipment and receiver.
- Connect the equipment into an outlet on a circuit different from that to which the receiver is connected
- Consult the dealer or an experienced radio/TV technician for help.

FCC Radiation Exposure Statement

This device complies with FCC radiation exposure limits set forth for an uncontrolled environment. This equipment must be installed and operated in accordance with provided instructions.

This device complies with part 15 of the FCC Rules. Operation is subject to the following two conditions:

- (1) This device may not cause harmful interference, and
- (2) this device must accept any interference received, including interference that may cause undesired operation.

Caution!

Any changes or modifications not expressly approved by the party responsible for compliance could void the user's authority to operate the equipment.

The SAR limit of USA (FCC) is 1,6 W/kg averaged over one gram of tissue. This device has been tested to complied FCC Specific Absorption Rate (SAR) compliance. The highest reported SAR level for usage near the body (0mm) is 0,173 W/kg.

Wireless adapter (ACC5100)

FCC Statement

This equipment has been tested and found to comply with the limits for a Class B digital device, pursuant to Part 15 of

the FCC Rules. These limits are designed to provide reasonable protection against harmful interference in a residential installation. This equipment generates uses and can radiate radio frequency energy and, if not installed and used in accordance with the instructions, may cause harmful interference to radio communications. However, there is no guarantee that interference will not occur in a particular installation.

If this equipment does cause harmful interference to radio or television reception, which can be determined by turning the equipment off and on, the user is encouraged to try to correct the interference by one or more of the following measures:

- Reorient or relocate the receiving antenna.
- Increase the separation between the equipment and receiver.
- Connect the equipment into an outlet on a circuit different from that to which the receiver is connected
- Consult the dealer or an experienced radio/TV technician for help.

FCC Radiation Exposure Statement

This device complies with FCC radiation exposure limits set forth for an uncontrolled environment. This equipment must be installed and operated in accordance with provided instructions and the antenna(s) used for this transmitter must be installed to provide a separation distance of at least 20 cm from all persons.

This device complies with part 15 of the FCC Rules. Operation is subject to the following two conditions:

- (1) This device may not cause harmful interference, and
- (2) this device must accept any interference received, including interference that may cause undesired operation.

Caution!

Any changes or modifications not expressly approved by the party responsible for compliance could void the user's authority to operate the equipment.

Canada Statement

SpeechMike Ambient (PSM5000)

This device contains licence-exempt transmitter(s)/receiver(s) that comply with Innovation, Science and Economic Development Canada's licence-exempt RSS(s). Operation is subject to the following two conditions:

- (1) This device may not cause interference.
- (2) This device must accept any interference, including interference that may cause undesired operation of the device.

The device meets the exemption from the routine evaluation limits of RSS 102 and compliance with RSS-102 RF exposure, users can obtain Canadian information on RF exposure and compliance.

This transmitter must not be co-located or operating in conjunction with any other antenna or transmitter.

The SAR limit of USA (FCC) is 1,6 W/kg averaged over one gram of tissue. This device has been tested to complied FCC

Specific Absorption Rate (SAR) compliance. The highest reported SAR level for usage near the body (Omm) is 0,173 W/kg.

Wireless adapter (ACC5100)

This device contains licence-exempt transmitter(s)/receiver(s) that comply with Innovation, Science and Economic Development Canada's licence-exempt RSS(s). Operation is subject to the following two conditions:

- (1) This device may not cause interference.
- (2) This device must accept any interference, including interference that may cause undesired operation of the device.

The device meets the exemption from the routine evaluation limits of RSS 102 and compliance with RSS-102 RF exposure, users can obtain Canadian information on RF exposure and compliance.

This transmitter must not be co-located or operating in conjunction with any other antenna or transmitter. This equipment should be installed and operated with a minimum distance of 20 centimeters between the radiator and your body.

Protect Your Hearing: Follow These Safety Guidelines

To minimize the risk of hearing damage when using your SpeechMike Ambient with headphones, please observe the following precautions:

Before using headphones

- Turn the volume control to its lowest setting before putting on the headphones.
- Put the headphones on.
- Gradually increase the volume to a comfortable level.

While using headphones

- Keep the volume as low as possible, especially in noisy environments where you might be tempted to raise the volume.
- If you need to increase the volume, do so slowly and cautiously.
- Be aware that ringing in the ears can be a sign that the volume is too high.
- If you experience discomfort or ringing in your ears, stop using headphones immediately and consult a physician.
- Discontinue use if the headphones cause significant discomfort.
- Prolonged use at high volume may cause your ears to adapt to the sound level, potentially leading to permanent hearing damage without noticeable discomfort.



Battery information

Produced in:	China
Weight:	8g
Capacity:	480 mAh
Chemical composition:	LiPo
Nominal Voltage:	3,7V



Open source software

Products mentioned in this manual may contain open source software.

Speech Processing Solutions GmbH hereby offers to deliver, upon request, a copy of the complete corresponding source code for the copyrighted open source software packages used in this product for which such offer is requested by the respective licenses. This offer is valid up to three years after product purchase. To obtain the source code, please write in English to: info@speech.com.

Neither Speech Processing Solutions GmbH nor its affiliates shall be liable to the purchaser of this product or third parties with respect to claims for damages, losses, costs or expenses incurred by purchaser or third parties as a result of an accident, misuse or abuse of this product or unauthorized modifications, repair, modification of the product or failure to meet the operating and maintenance instructions provided by the manufacturer.

This user manual is a document with no contractual nature. We accept no liability for changes, mistakes or printing errors.



Issue date 2026-03-03

© 2026 Speech Processing Solutions GmbH. All rights reserved.

Specifications are subject to change without notice. Philips and the Philips shield emblem are registered trademarks of Koninklijke Philips N.V. and are used by Speech Processing Solutions GmbH under license from Koninklijke Philips N.V. All trademarks are the property of their respective owners.